

REV	DESCRIPTION	INIT. BY	REVISION DATE
A	COUNCIL DA ISSUE		25.3.16

NOTE:

1. Contractors must verify all dimensions at the site before commencing any work or making any shop drawings which must be approved before manufacturing.
2. Do not scale drawing, if in doubt - ASK
3. This drawing is to be read in conjunction with Architectural, Hydraulic and survey plans
4. All Existing trees to remain shall be protected as per arborist report & council requirements
5. All pruning shall be in accordance with the AS 4373
6. Thoroughly eradicate weeds from all garden areas.
7. No variation to the works to be carried out without prior approval from owner.
8. All materials to be the best of their respective kinds and shall comply with approved sample type submitted or specified.
9. Substitution of plant species or varieties will not be permitted.
10. Unless otherwise specified or directed, all instructions are to be issued by the consulting landscape designer.
11. All storm water outlets & surface run off shall be to Hydraulic Engineers detail.
12. Provide sub-soil drainage to garden beds & lawn areas where required - To be confirmed on site.
13. Refer to survey plan for position of all existing services.
14. Refer to Architectural elevations & Sections for existing and proposed ground lines.
15. All landscape works shall comply with all councils DA & CC conditions and all relevant "AUSTRALIAN STANDARDS" and AUS SPEC NO.1 Specification C273-Landscaping.
16. Irrigation system - If required, shall be designed & installed to comply with AS 2698, AS 2698.1-1994, AS 2698.2-1985, AS 2698.3-1990, water board and other relevant authority regulations.

MAINTENANCE- All landscape works are to be maintained for a period of 12 months after final completion. Replace all plants which have failed with the same species. Mulch is to be maintained at specified depth. All plants and turf shall be watered on a regular basis to maintain moisture levels required for optimum growth. All garden areas are to be maintained free from weeds.

PROPOSED HOME UNITS
116-124 Restwell Street,
Bankstown

ARCHITECT:
Design Cubicle Pty. Ltd.



DRAWING TITLE

LANDSCAPE CONCEPT
PLAN

DRAWN	FF	SCALE	1:100@A1 OR 1:200@A3	REV.
DRAWING NUMBER				A
16011 DA 1-2				
MEMBER				



LEGEND / FINISHES SCHEDULE

	EXISTING RL
	EXISTING TREE TO BE REMOVED
	EXISTING TREE TO BE RETAINED
	PROPOSED TREES, SHRUBS & GROUND COVER (REFER NO. TO PLANT SCHEDULE)
	SELECTED BRICK GARDEN EDGE OR AS SELECTED REFER TO DETAIL 1
	LAWN AREA SIR WALTER BUFFALO REFER TO DETAIL 1
	PEBBLE AREA SELECTED 100 DEPTH RIVER PEBBLES WITH WEED MAT UNDER
	DRIVEWAY / PATH SELECTED STENCILED CONCRETE
	PATIO / TERRACE / PATH SELECTED TILES
	SELECTED LETTER BOX TO AUST POST REQUIREMENTS
	SELECTED AUTOMATIC BOLLARD ILLUMINATION IN ACCORDANCE WITH AS 4282 & AS 1158
	STORM WATER PIT TO ENGINEER DETAIL

ITEM	MATERIAL
SOIL	NOTE: ALL SOIL TYPE AS PER AUST. NATIVE LANDSCAPE SUPPLY OR EQUIVALENT
LAWN AREA	1st QUALITY TOP SOIL
NATIVE GARDEN BED	NATIVE GARDEN MIX
EXOTIC GARDEN BED	ORGANIC GARDEN MIX
MULCH	SELECTED HARD WOOD CHIP DECORATIVE GRAVEL TO OSD AREA REFER TO DETAIL 1 & 2
PLANT MATERIAL	AS PER PLANT SCHEDULE REFER TO DETAIL 2
GARDEN EDGE	SELECTED PRESSED BRICK OR AS SELECTED REFER TO DETAIL 1
RETAINING WALL & PLANTER BOX	SELECTED MASONRY RETAINING WALL AND DRAINAGE TO ENG. DETAIL
FENCE	
SIDES & REAR BOUNDARY	1800 HIGH LAPPED & CAPPED TIMBER FENCE OR 1800 HIGH COLOURBOND
COURTYARD SEPERATION FENCE	1800 HIGH LAPPED & CAPPED TIMBER FENCE OR 1800 HIGH COLOURBOND
FRONT	REFER TO ARCHTECT'S DETAIL
IRRIGATION	PROVIDE DRIP IRRIGATION SYSTEM TO ALL PLANTER BOXES IN ACCORDANCE WITH AS3500 AND SYDNEY WATER CODE IRRIGATION SHALL BE DESIGNED & INSTALLED BY QUALIFIED IRRIGATION

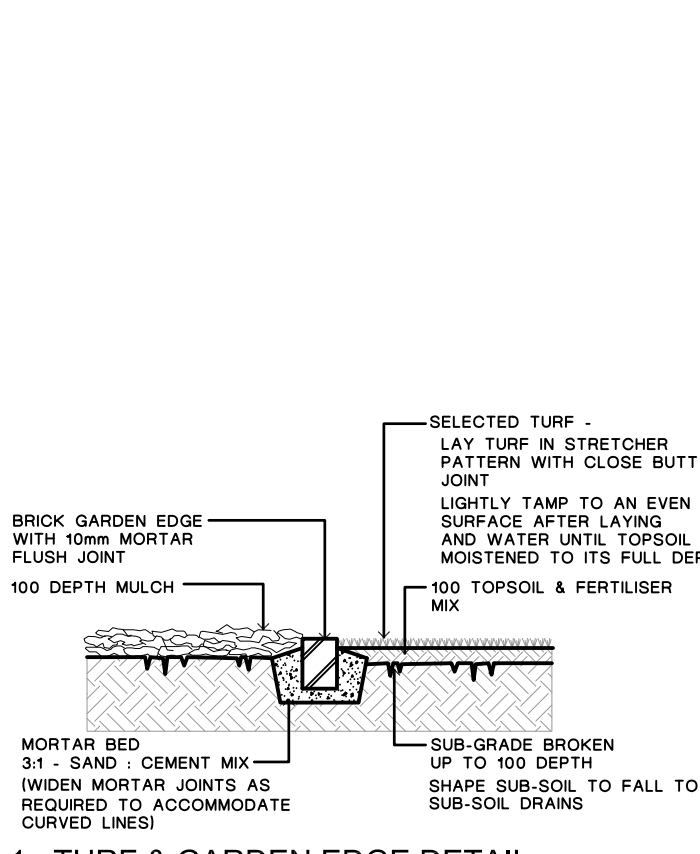

1. TURF & GARDEN EDGE DETAIL

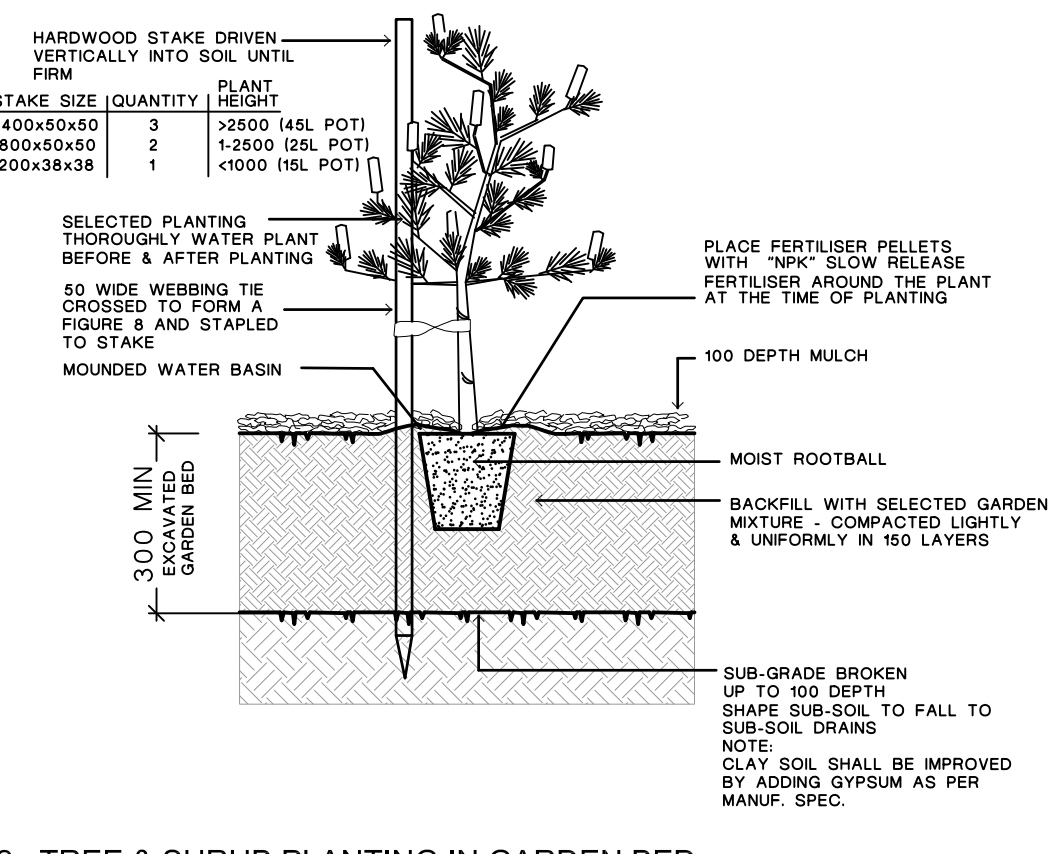

2. TREE & SHRUB PLANTING IN GARDEN BED

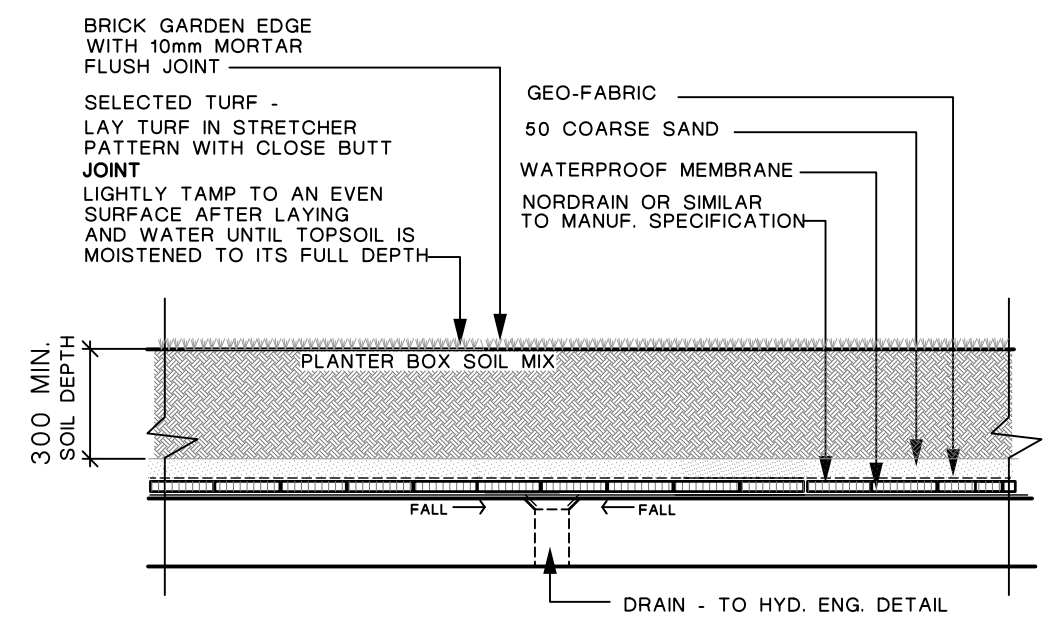

4. PODIUM TURF DETAIL

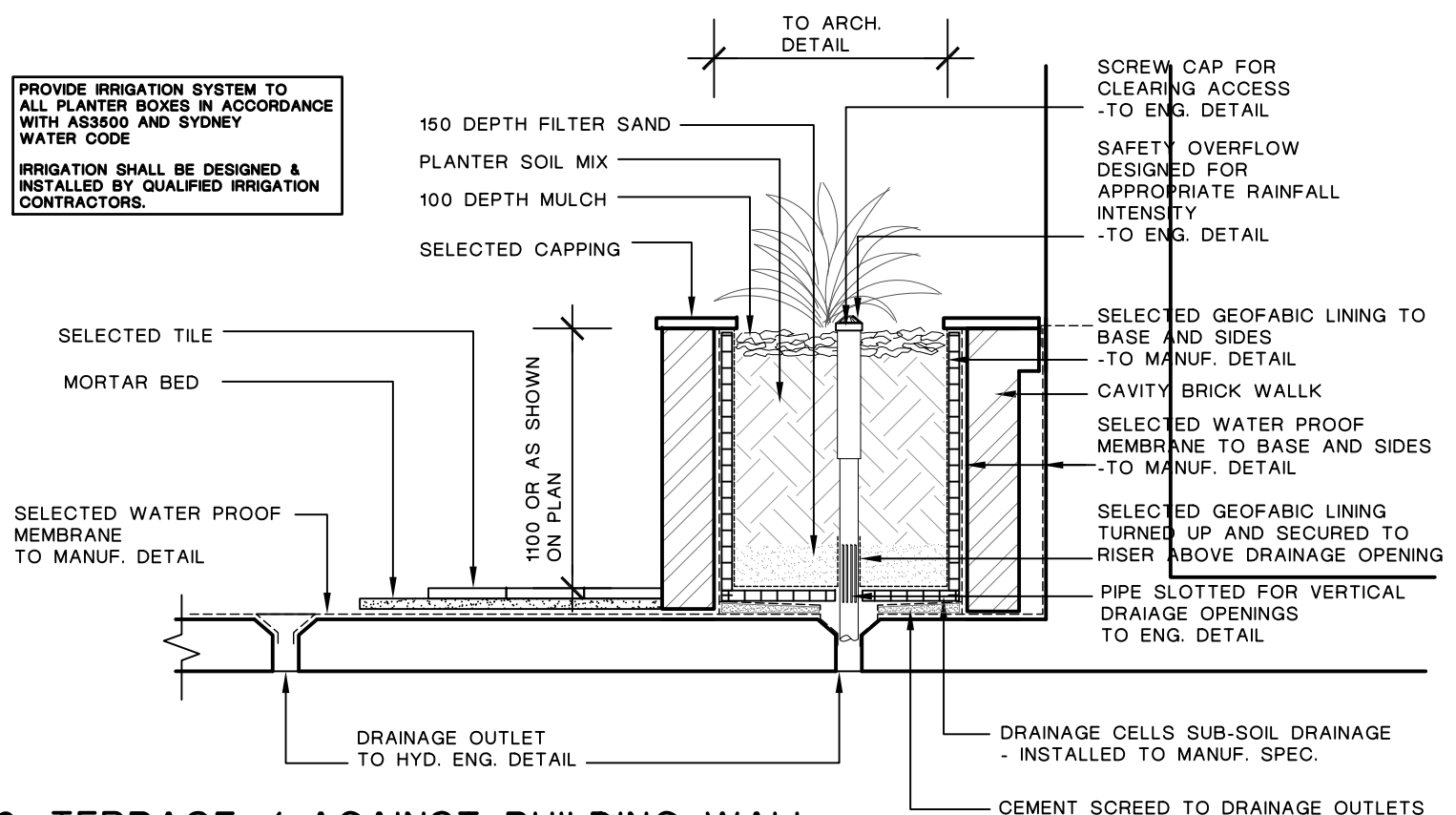

3. TERRACE / AGAINST BUILDING WALL PLANTER BOX DETAIL

PROPOSED PLANT SCHEDULE

No.	BOTANICAL NAME	COMMON NAME	APPROX MATURED HEIGHT	POT SIZE	QUANTITY
GROUND COVER / BOARDER					
2	Lomandra 'TANIKA'	Dwarf Lomandra	0.75	150mm	11
4	Liriope muscari 'Just Right'	Just Right Liriope	0.5	150mm	199
5	Dianella tasmanica 'Destiny'	Destiny Flax Lily	0.4	150mm	85
7	Phormium Chocomint Mist	Chocomint Mist	0.5	150mm	21
8	Aspidistra elatior	Cest-Iron Plant	0.8	150mm	124
9	Trachelospermum 'Tri colour'	Star Jasmine	0.2	150mm	109
10	Sansevieria trifasciata	mother in law's tongue	0.6	150mm	25
LOW SHRUBS					
11	Buxus microphylla Japonia	Japanese box	1	5 L	83
13	Philodendron Xanadu	Xanadu	0.7	5 L	87
15	Correa alba	White Correa	1.5	5 L	5
16	Murraya paniculata	Murraya	1.5	5 L	53
18	Dodonaea viscosa 'Purpurea'	Purple-leaved Hop bush	2	5 L	22
19	Acmena 'Allyn's Magic'	Lilly pilly	1.5	5 L	34
20	Westringia fruticosa	Westringia	1.5	5 L	9
TALL SHRUBS					
21	Callistemon citrinus	crimson bottlebrush	4	5 L	5
25	Syzygium australe 'Resilience'	Lilly pilly	4	5 L	83
29	Camellia sasanqua 'Yuletide'	Yuletide Camelia	1.5	5 L	5

FEATURE SHRUBS					
31	Cordyline stricta	Slender palm lily	3	5 L	27
32	Rhaphis excelsa	Lady palm	2.5	5 L	16
33	Cyathea australis	Tree fern	4	5 L	6
35	Cordyline 'Red Sensation'	Red Sensation	1.2	5 L	20
36	Cycas revoluta	Sago Palm	1.5	25 L	4
37	Strelitzia reginae	Bird of Paradise	1.2	5 L	3
38	Strelitzia nicolai	Giant Bird of Paradise	5	5 L	2
40	Alpinia zerumbet variegata	Variegated Shell Ginger	1.5	5 L	58
TREES					
42	Pyrus ussuriensis	Manchurian pear	9	25 L	5
43	Elaeocarpus reticulatus	Blue berry ash	8	25 L	23
44	Tristanopsis laurina 'luscious'	Water box	7	25 L	4
46	Acer palmatum Senkaki	Coral Bark Maple	5	45 L	9
47	Cupaniopsis anacardioides	Tuckeroo	6	25 L	4
48	Magnolia Little Gem	Magnolia	5	45 L	13
50	Howea forsteriana	Kentia Palm	10	45 L	15
51	Fraxinus griffithii	Evergreen ash	7	25 L	4

REV	DESCRIPTION	INIT. BY	REVISION DATE
A	COUNCIL DA ISSUE		25.3.16

NOTE:

- Contractors must verify all dimensions at the site before commencing any work or making any shop drawings which must be approved before manufacturing.
- Do not scale drawing, if in doubt - ASK
- This drawing is to be read in conjunction with Architectural, Hydraulic and survey plans
- All Existing trees to remain shall be protected as per arborist report & council requirements
- All pruning shall be in accordance with the AS 4373
- Thoroughly eradicate weeds from all garden areas.
- No variation to the works to be carried out without prior approval from owner.
- All materials to be the best of their respective kinds and shall comply with approved sample type submitted or specified.
- Substitution of plant species or varieties will not be permitted.
- Unless otherwise specified or directed, all instructions are to be issued by the consulting landscape designer.
- All storm water outlets & surface run off shall be to Hydraulic Engineers detail.
- Provide sub-soil drainage to garden beds & lawn areas where required - To be confirmed on site.
- Refer to survey plan for position of all existing services.
- Refer to Architectural elevations & Sections for existing and proposed ground lines.
- All landscape works shall comply with all councils DA & CC conditions and all relevant "AUSTRALIAN STANDARDS" and AUS SPEC NO.1 Specification C273-Landscaping.
- Irrigation system - If required, shall be designed & installed to comply with AS 2698, AS 2698.1-1994, AS 2698.2-1985, AS 2698.3-1990, water board and other relevant authority regulations.

MAINTENANCE: All landscape works are to be maintained for a period of 12 months after final completion. Replace all plants which have failed with the same species. Mulch is to be maintained at specified depth. All plants and turf shall be watered on a regular basis to maintain moisture levels required for optimum growth. All garden areas are to be maintained free from weeds.

PROPOSED HOME UNITS
116-124 Restwell Street,
Bankstown

ARCHITECT:
Design Cubicle Pty. Ltd.



DRAWING TITLE
LANDSCAPE CONCEPT
PLAN

DRAWN FF	SCALE 1:100@A1 OR 1:200@A3	REV. A
DRAWING NUMBER 16011 DA 2-2		

